

	<div><div></div></div> Luminaire A	<div><div></div></div> Luminaire B	<div><div></div></div> Luminaire C
Supplier	Urbis Schreder		
Type	AXIA 3.3 5266 Integrated lenses Front louvers 64 OSLO SQUARE	AXIA 3.3 5267 Integrated lenses Front-Rear louvers 64 OSLO SQUARE	AXIA 3.3 5267 Integrated lenses 64 OSLO SQUARE GIANT@8
Lamp(s)	64 OSLO SQUARE GIANT@30 0mA VVV 730 230V 00-36-649	64 OSLO SQUARE GIANT@88 0mA VVV 730 230V 00-25-842	64 OSLO SQUARE GIANT@88 0mA VVV 730 230V
Lamp Flux (klm)	7.50	12.62	20.18
Maintenance Factor	0.83	0.83	0.83
No. in Project	10	4	14

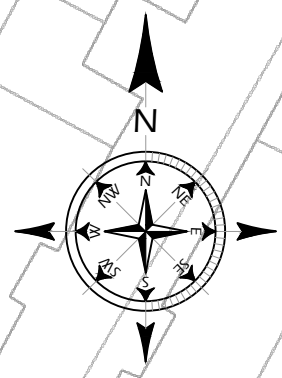
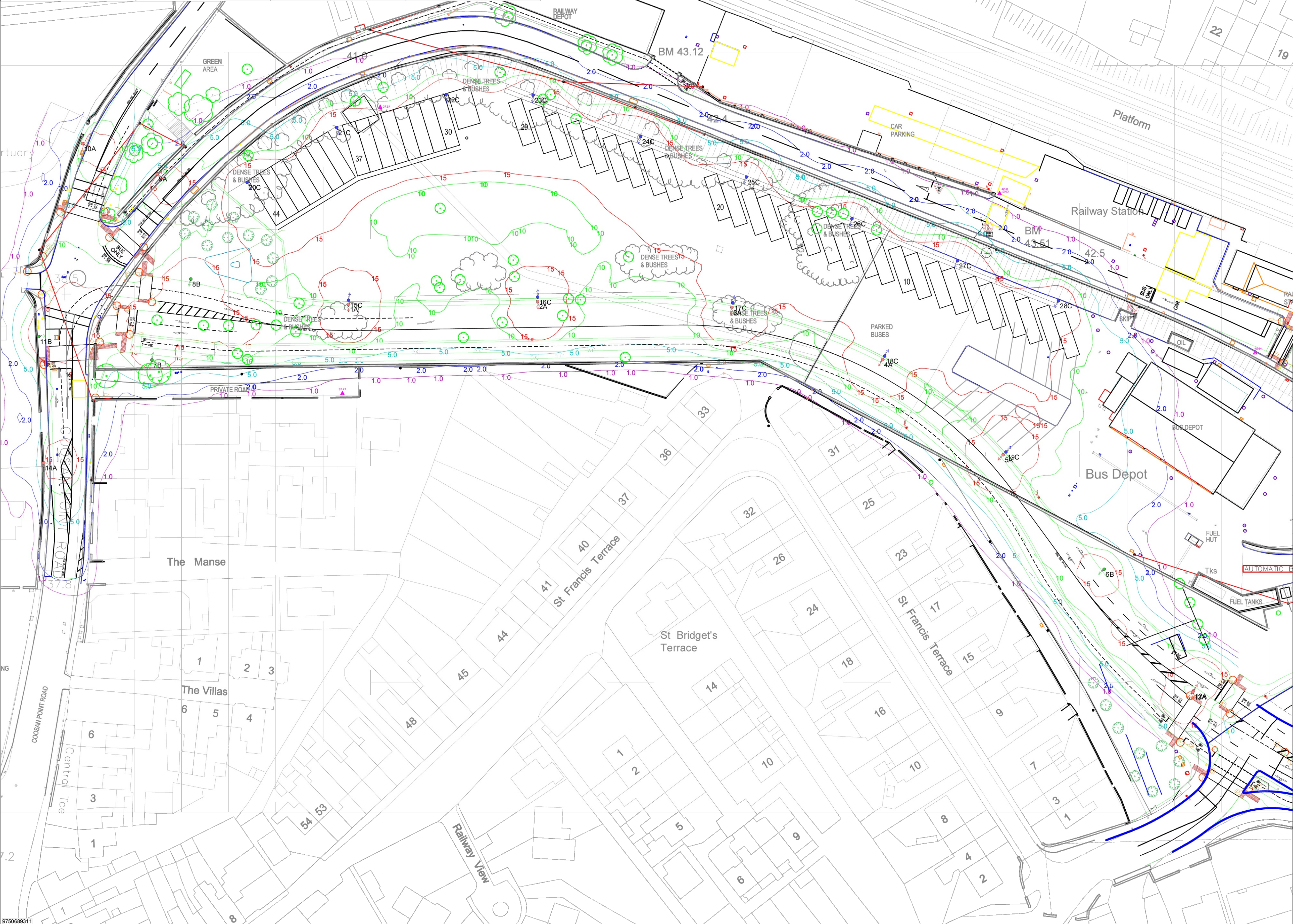

PROJECT NAME:		ATHLONE LINK ROAD	
PROJECT No:		WCC-2025-R4	
SCALE:	1:500	DATE:	13 May 2025
CALCULATION: Horizontal Illuminance (lux)			
DESIGNER:		D.Larkin	
Designed to achieve: P2 Lighting Class on roadway as per BS5489-1:2020 P3 Lighting Class on Footpath/Cycleway as per BS5489-1:2020 C3 Lighting Class for conflict areas as per BS5489-1:2020 Medium usage Traffic for Carpark areas as per BS5489-1:2020 20% Minimum uniformity on roadway & footpath/cycleway 40% Minimum uniformity for conflict areas 25% Minimum uniformity on carpark 10.0m Columns 2700Kelvin Colour Temp Luminaires Used Louvers used where applicable to reduce impact on nearby Residential Developments. "Electric Skyline confirms that this Design complies with relevant Lighting Standards. However as the Design was prepared on a Desktop basis, Electric Skyline assumes no responsibility or liability for any errors or omissions which may occur due to varying conditions on the Project site. This Design is provided on a provisional basis only, with no guarantees of completeness or accuracy until on-site surveys are completed by associated Contractors and all Safety Rules and Codes of Practice have been taken into consideration."			
PREPARED BY:		Electric Skyline Ltd CRF House, Dalton St, Claremorris, Co. Mayo, F12 N2Y2 e-mail: info@electricskyline.ie www.electricskyline.ie	